

INSTRUMENTS • CONTROLS • VALVES

ARCO
Engineering, Inc.
SINCE 1954
www.arcoengineering.com

3317 Gilmore Industrial Blvd.
Louisville, KY 40213

Ph: (502) 966-3134
Fx: (502) 966-3135

MULTIPLE MODELS

CAPILLARY ALTERNATIVE:
WHEN USING CAPILLARY TUBE, THE GAUGE
REQUIRES A MOUNTING BRACKET OR OTHER
MOUNTING DEVICE.

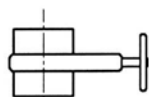
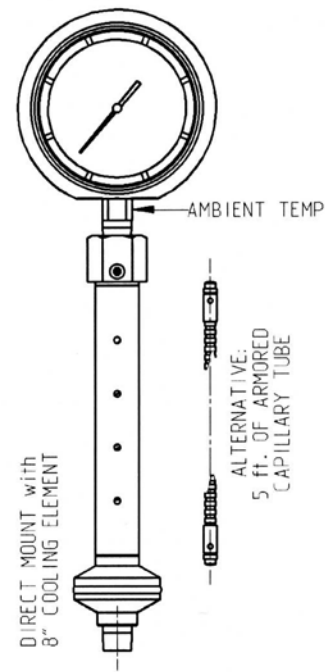
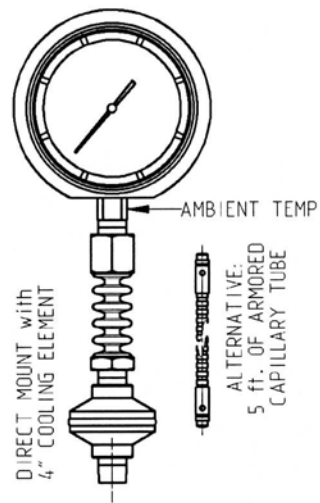
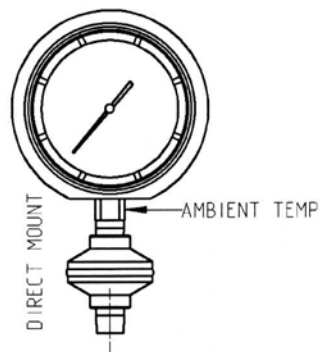
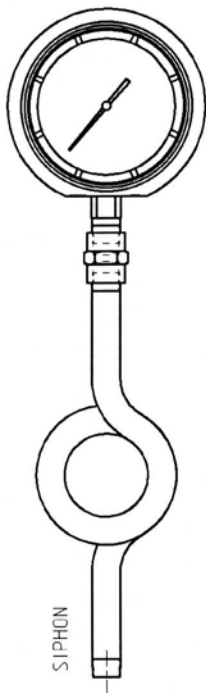

TYPICAL STEAM APPLICATION

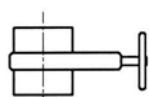

300°F

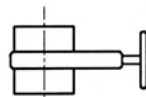

500°F

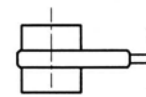

750°F

PROCESS TEMPERATURE

HIGH TEMPERATURE SEAL DESIGN

IT IS RECOMMENDED THAT THESE ASSEMBLIES ARE BACK WELDED.

GAUGE-SEAL PN292;

REV	E.C. NO.	NAME	COMPARISON CHART for TEMPERATURE APPS GAUGE/SEAL ASSEMBLY OPTIONS				DWG. NO
							50493469-45 REV 0
		MATERIAL	SCALE	DRAWN	04/28/08	TULSH	SHEET 1 OF 1
			3:16	APPROVED			PRODUCT CODE 014
		UNLESS OTHERWISE SPECIFIED	CRITICAL DIMENSIONS	ISO A	THIS DOCUMENT AND ALL INFORMATION HEREON IS THE PROPERTY OF WIKA INSTRUMENT CORPORATION AND MAY NOT BE REPRODUCED WITHOUT THEIR WRITTEN PERMISSION		WIKA INSTRUMENT CORP.
		FRACTIONS ± 1/64	Units				Lawrenceville, GA 30043 www.wika.com
		XX DECIMALS ± .01	[in]				
		XXX DECIMALS ± .005					
		ANGLES ± 1/2°					
		Ra (MAXIMUM) = 125 µin					
		FIRST RELEASE 04/24/08					